

Highly Appreciating Plots

SAI POOJA AVENUE

WEST THAMBARAM - ORR



Let Prosperity Flow in to Your Life Now!

AREA SHOWING THE SURVEYED BOUNDARY OF S.NO. 408/2, 412/2,3,4, 413/1B,
PAZHANTHANDALAM VILLAGE, SRIPERUMBUDUR TALUK,
KANCHEPURAM DISTRICT

Sai Pooja Avenue

PREMIUM HIGH APPRECIATING PLOTS ON THE OUTER RING ROAD

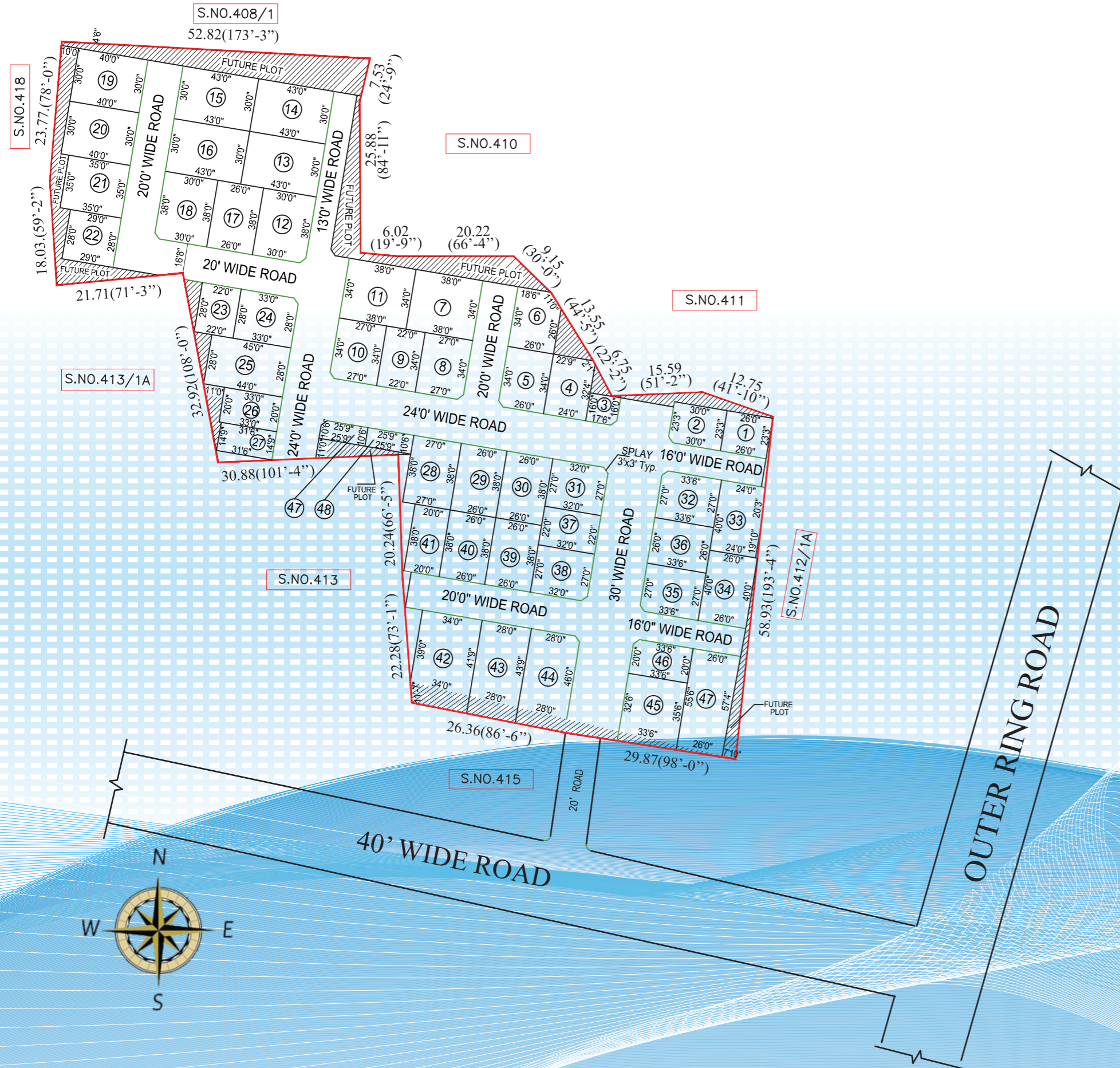

SI. No	EXTENT
1	604
2	692
3	275
4	808
5	879
6	854
7	1292
8	913
9	748
10	913
11	1292
12	1135
13	1290
14	1290
15	1290
16	1290
17	988
18	1135
19	1200
20	1200
21	1225
22	812
23	616
24	919

SI. No	EXTENT
24	919
25	1260
26	660
27	464
28	1026
29	988
30	988
31	859
32	899
33	960
34	1040
35	899
36	871
37	704
38	864
39	988
40	988
41	760
42	1373
43	1197
44	1251
45	1139
46	670
47	1465

Location Map

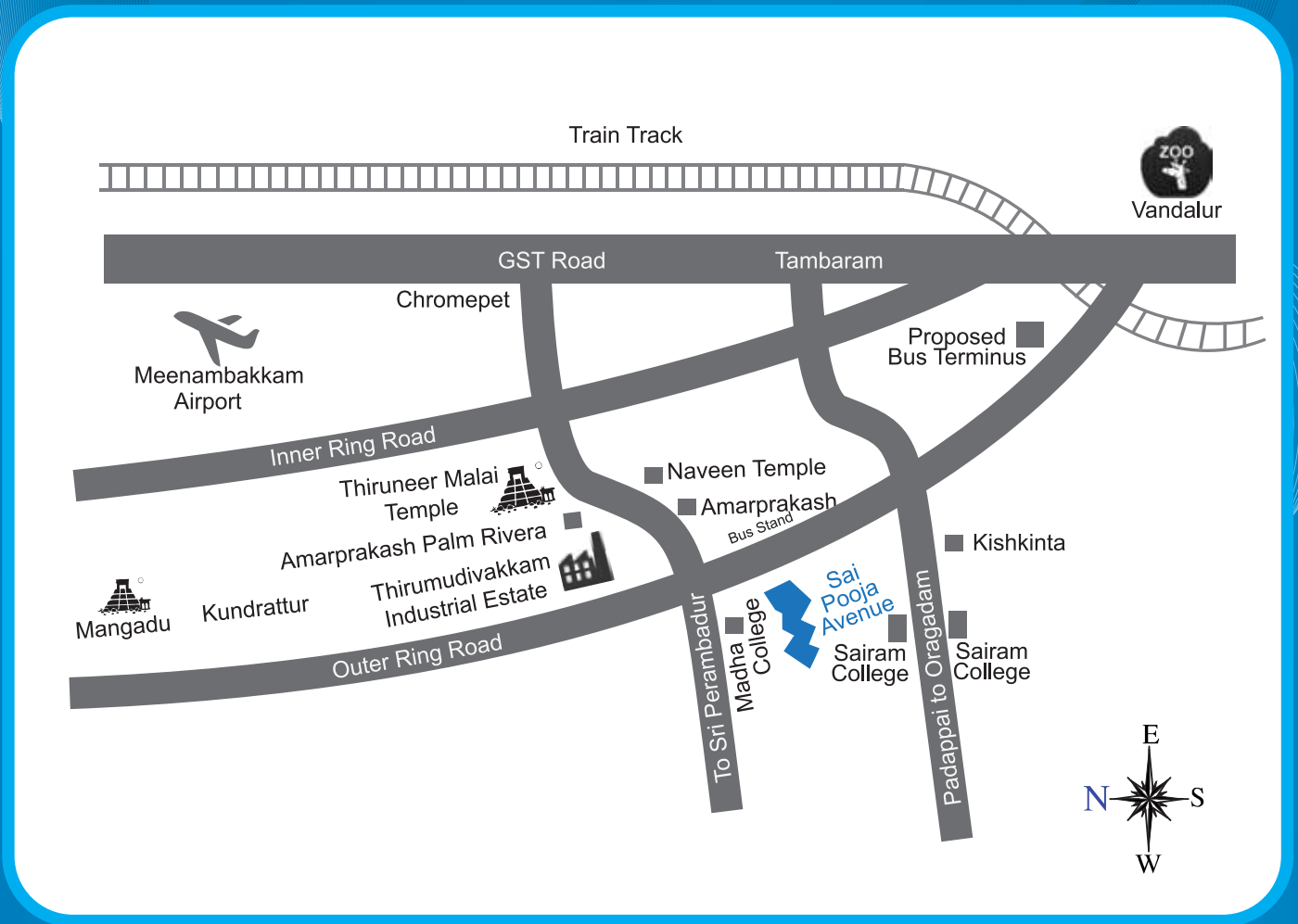

Amenities

Well connected by town bus, share auto etc. | Excellent potable ground water at 20 feet | Fully fenced layout.

Key Features

300 mts from Palanthandalam Bus stand and Outer Ring Road

5 KM from Proposed Vandalur Bus Terminal

3 KM from Amarprakash Palm Riviera,

6 KM from Tambaram Bus Stand and Railway Station

Amarprakash Temple Waves, Naveen Temple View

10 KMS from Chennai Airport

2 KM from Thirumudivakkam SIPCOT